

WISS-Bot 1.0

Chassis

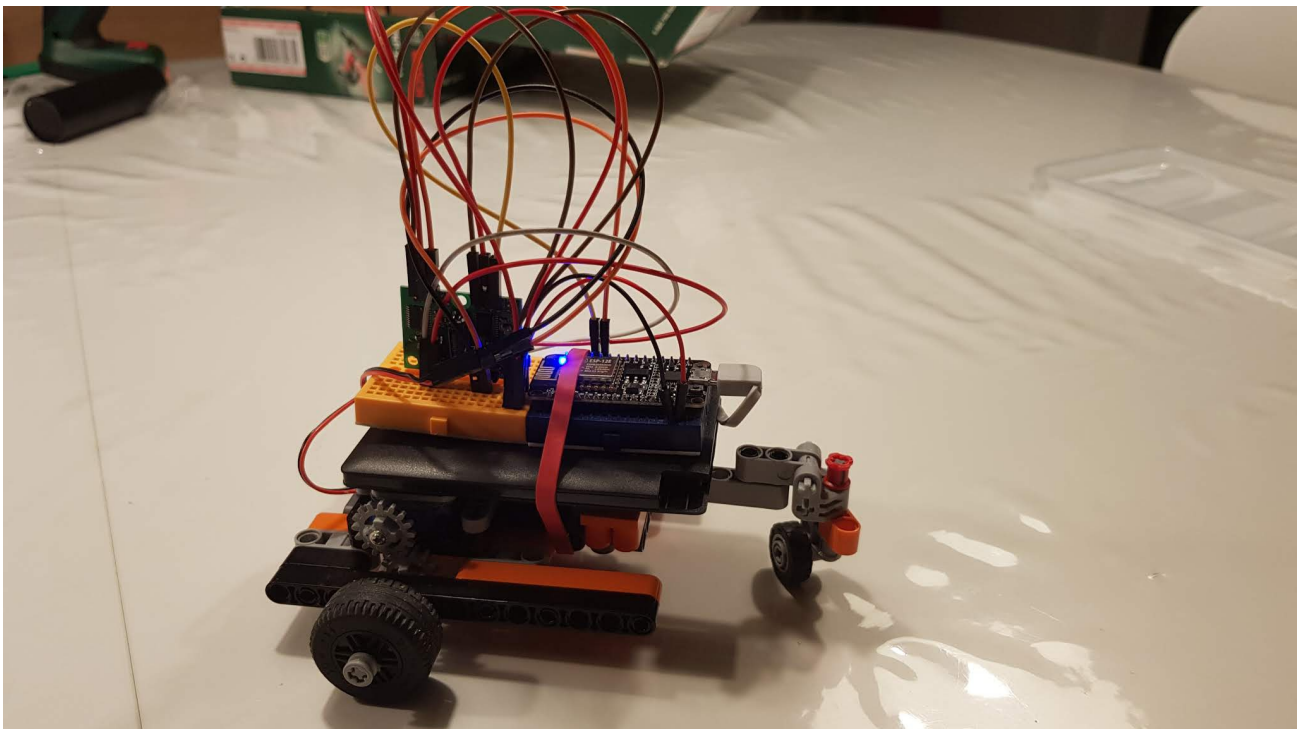
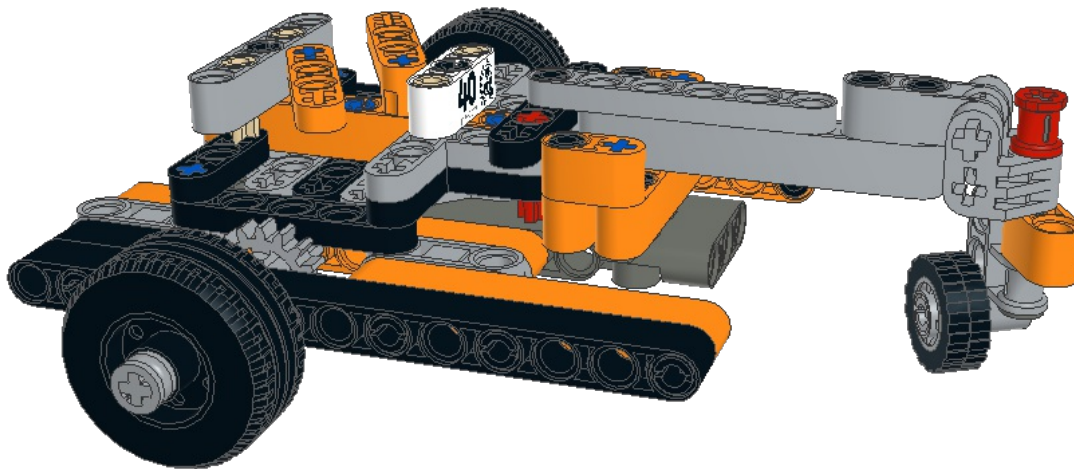

<http://wisslab.org/wissbot>

This model was developed by Kai Eckert for the
WISS Research Group at Stuttgart Media University.

August 2018



All parts used in this model
are contained in this set:

42060 - Roadwork Crew



LEGO® is a registered trademark of the LEGO Group,
which does not sponsor, endorse, or authorize these
instructions or the model they depict.

Prof. Dr. Kai Eckert
WISS Research Group
Stuttgart Media University

Nobelstr. 10
D-70569 Stuttgart
Germany

<http://www.wisslab.org>

1

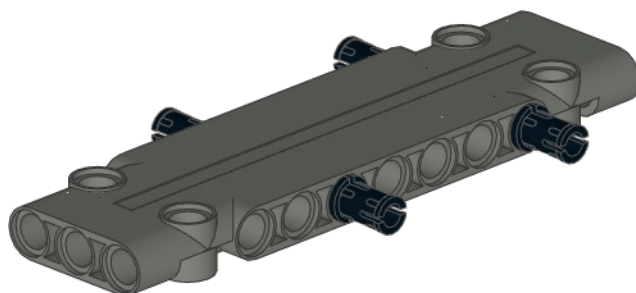
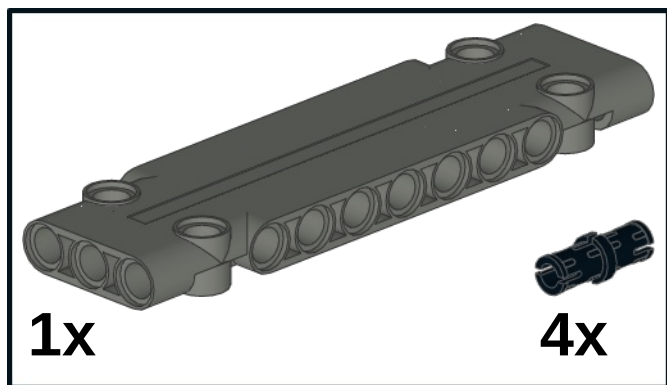

Wheel (2x)

1

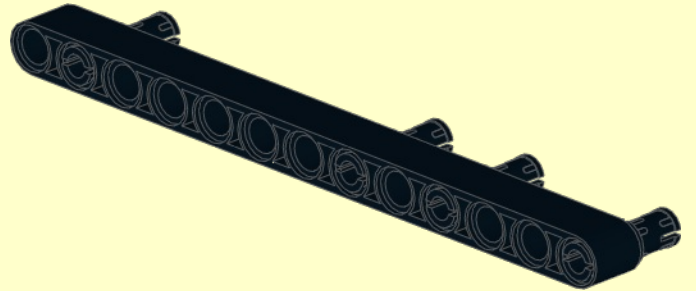
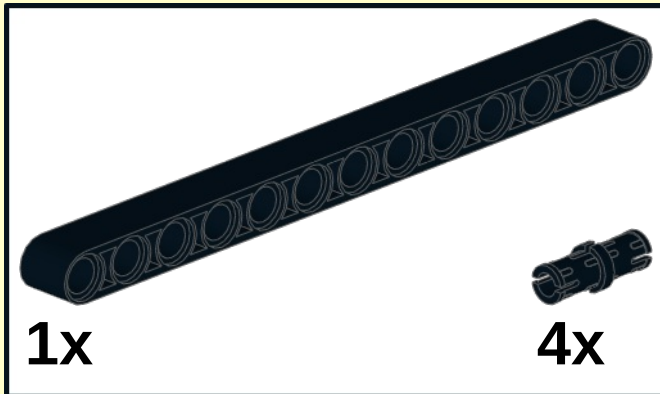

2

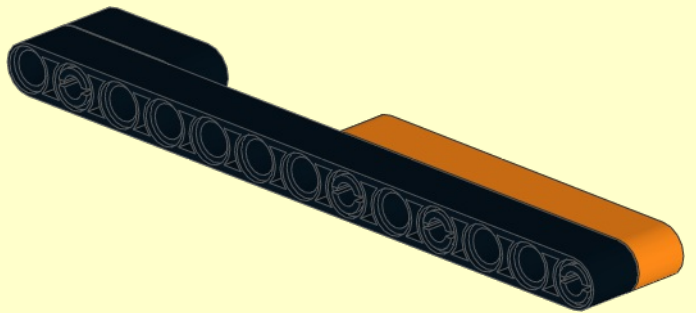
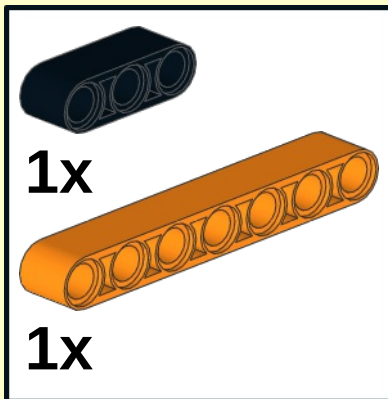

3

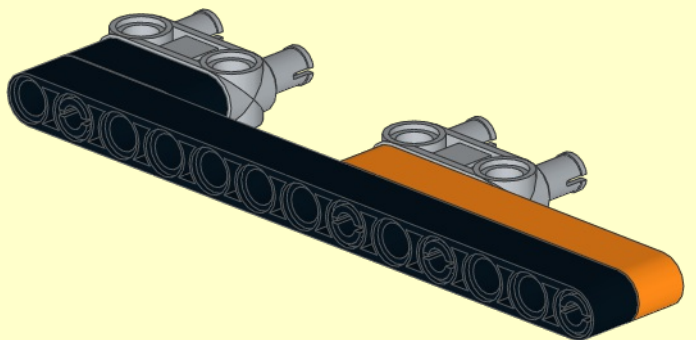
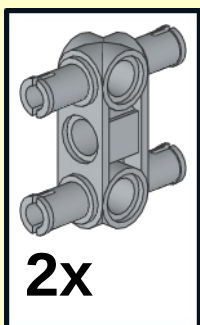

4

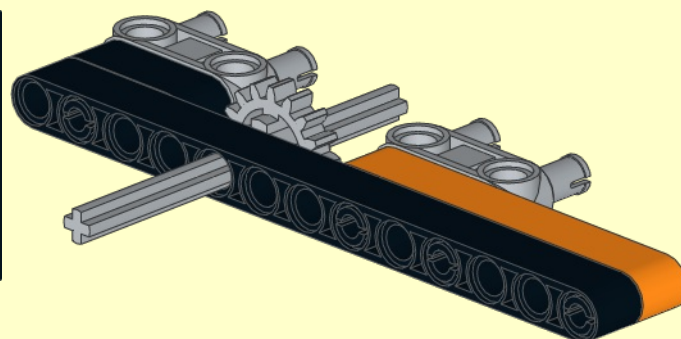
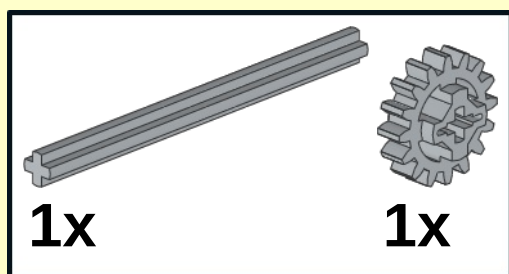

5

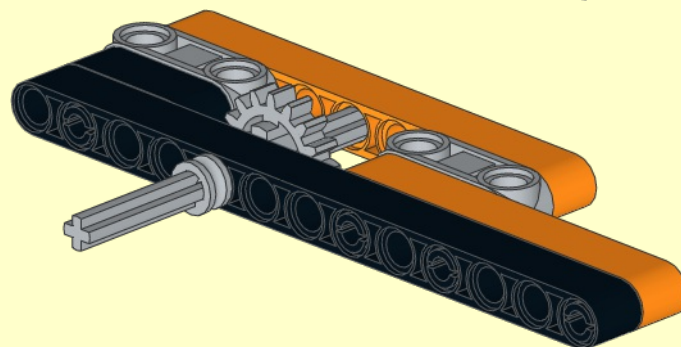
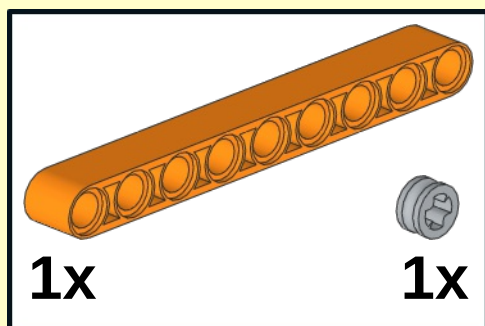

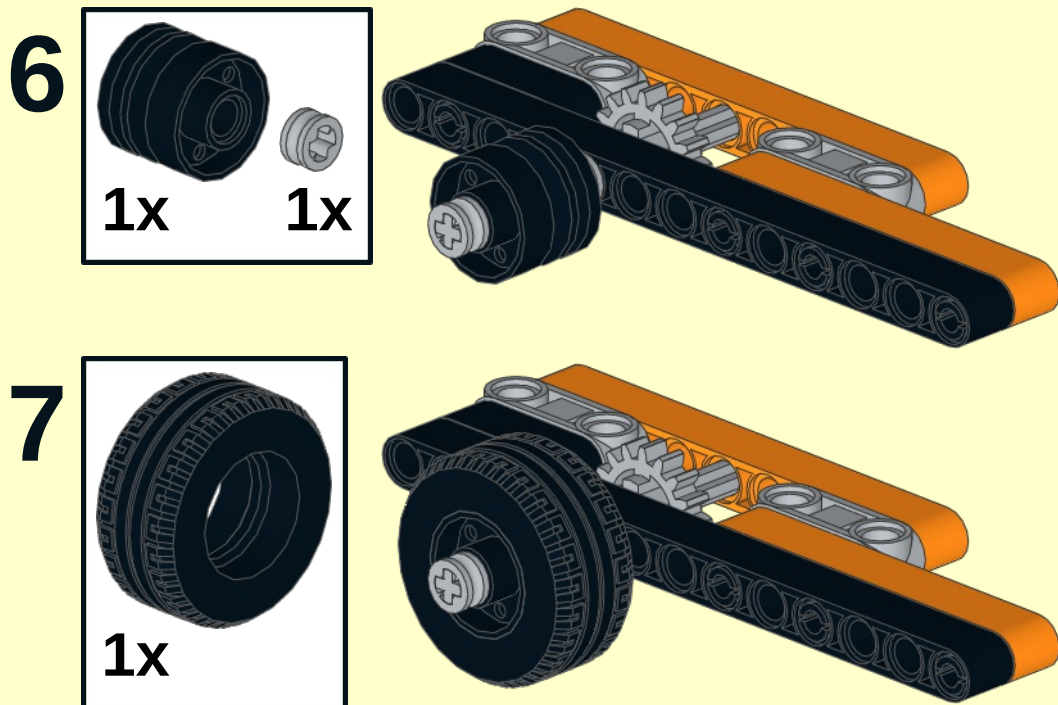

**Insert a rubber band between
axle and wheel to lock the wheel.**

Cut the ends of the rubber band.

x2

2

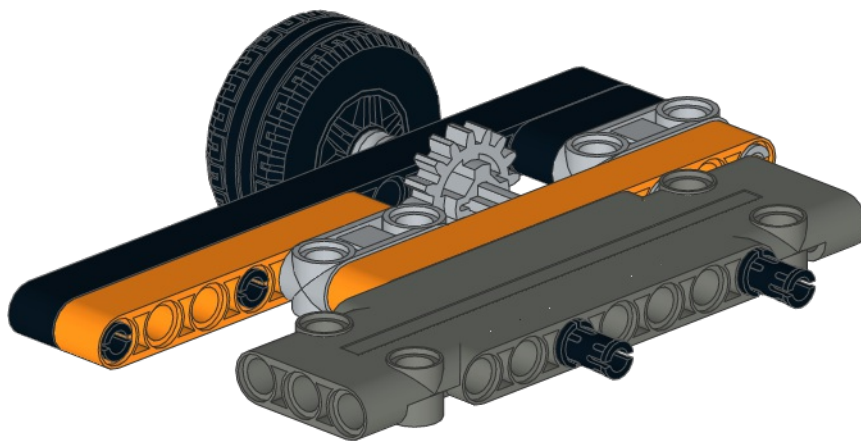

3

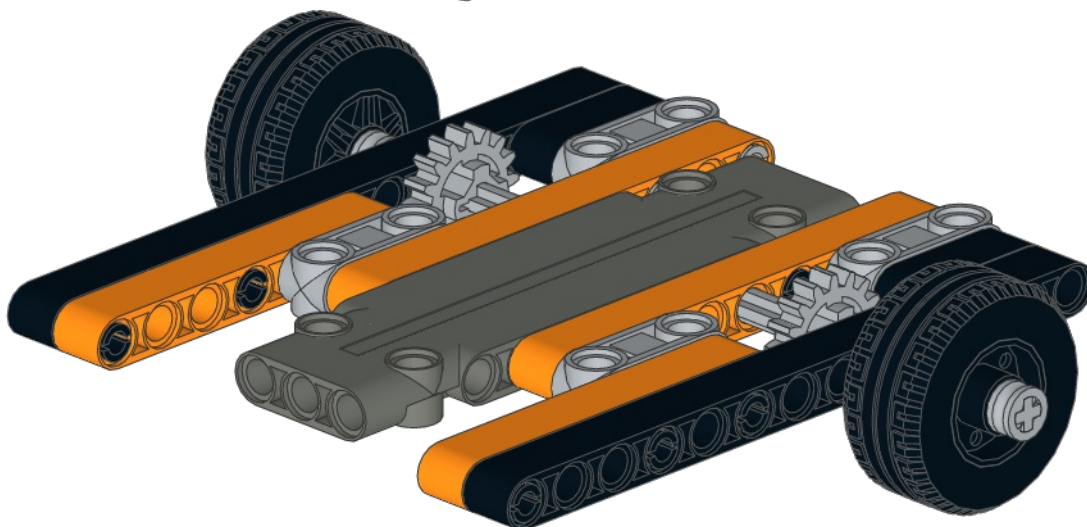

Platform for the motors

1

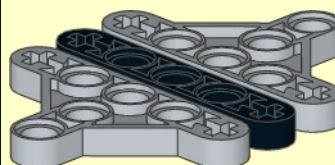
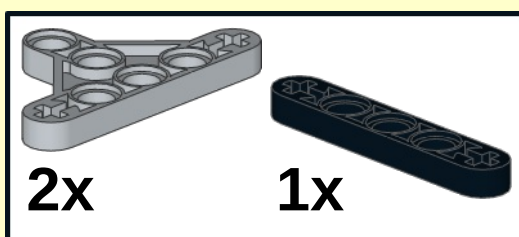

2

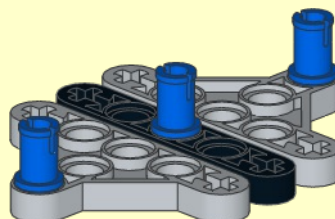

3

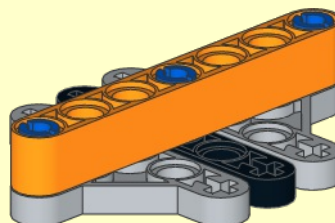
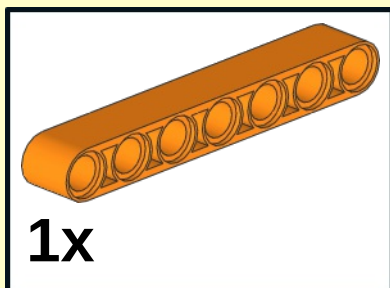

4

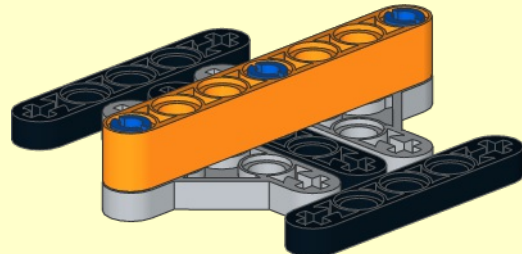

5

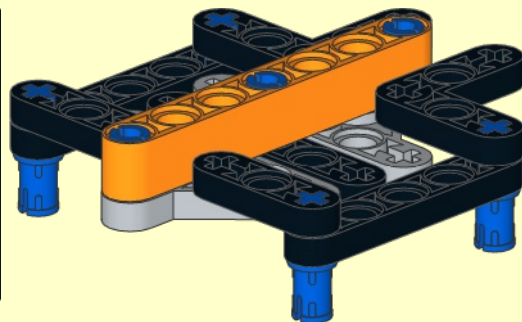
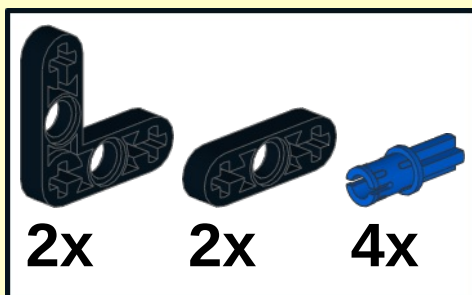

6

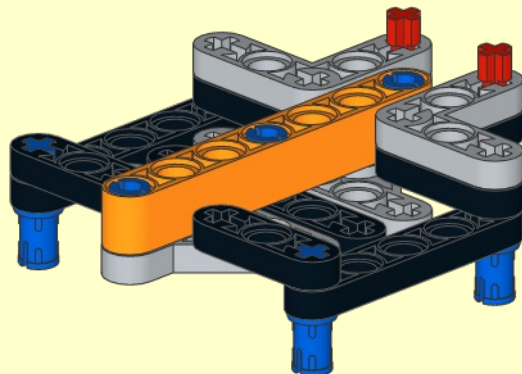
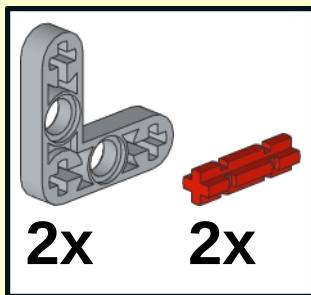

7

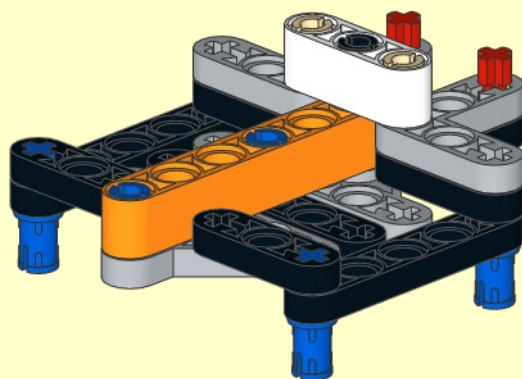
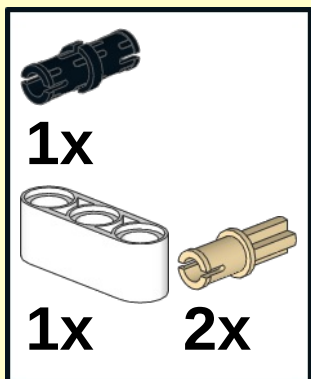

8



1x

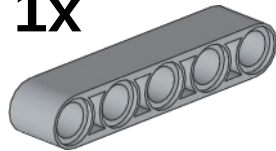

1x

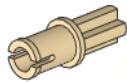

2x

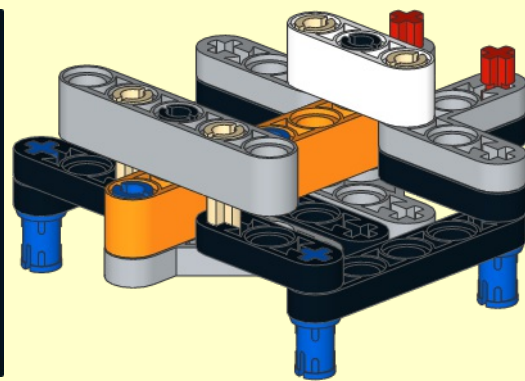

9



2x

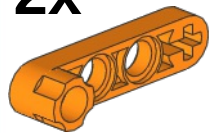

2x

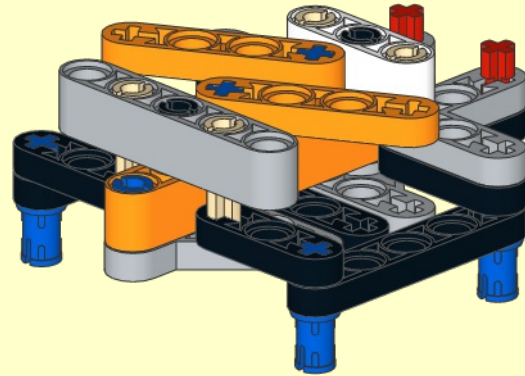

4

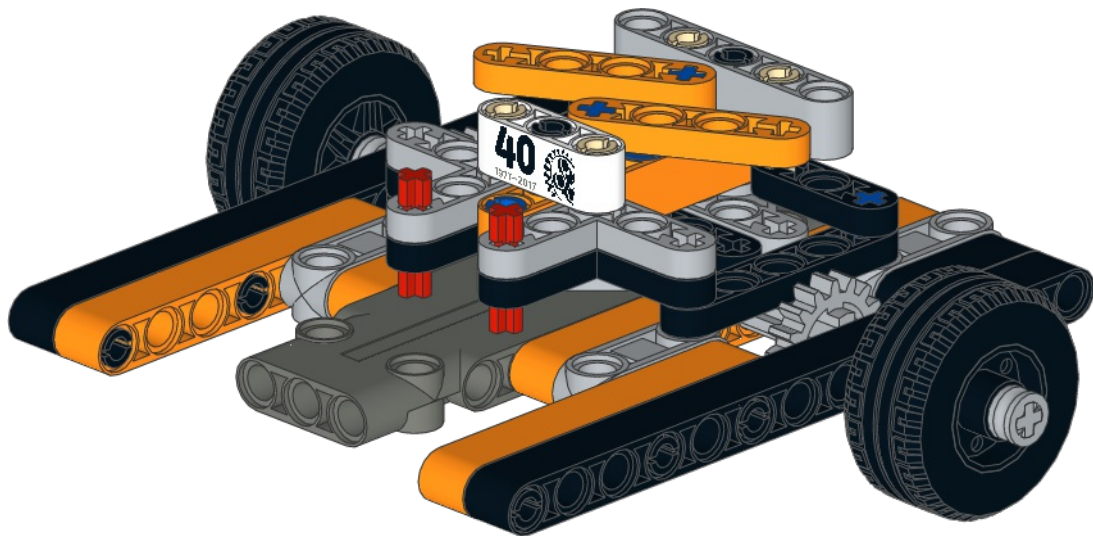

Front wheel

1

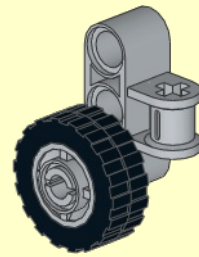
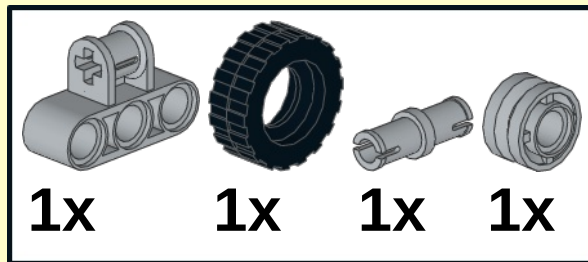

2

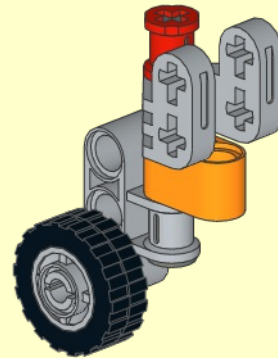
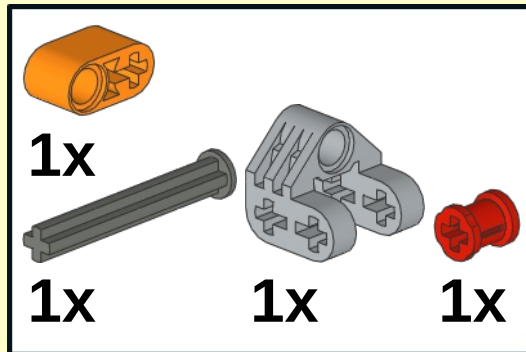

3

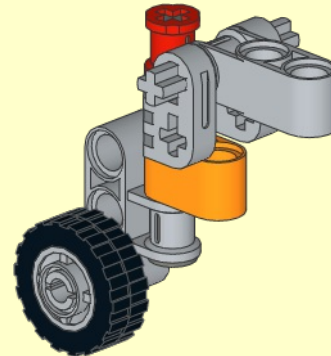
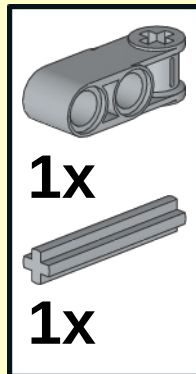

4

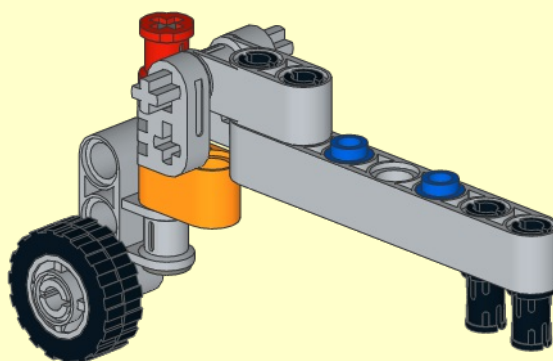
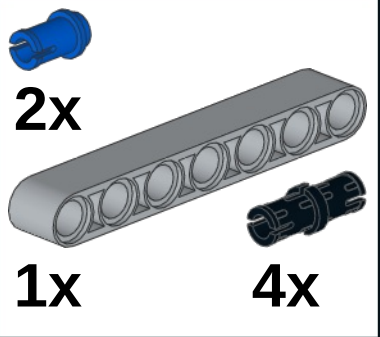

5

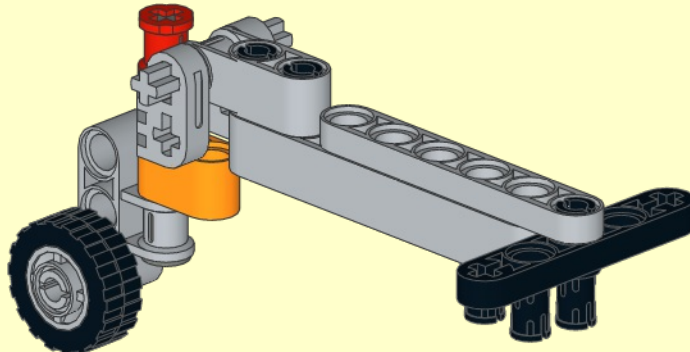
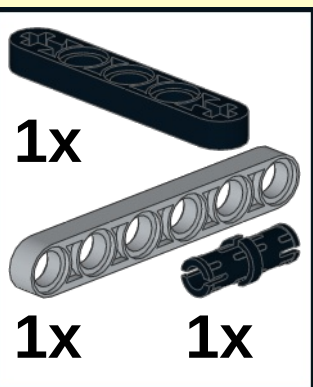

6

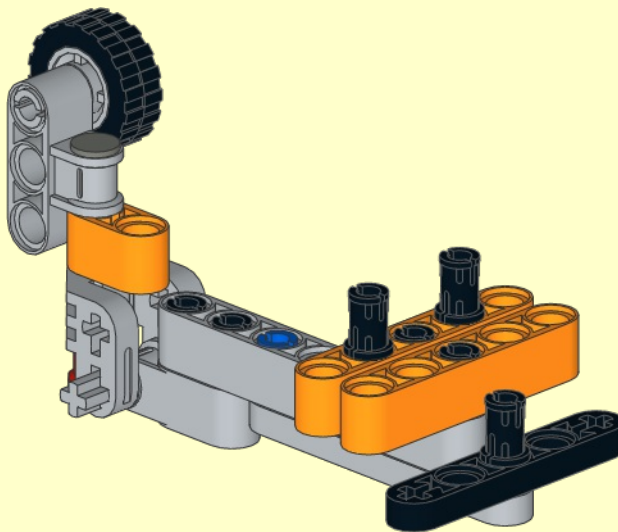
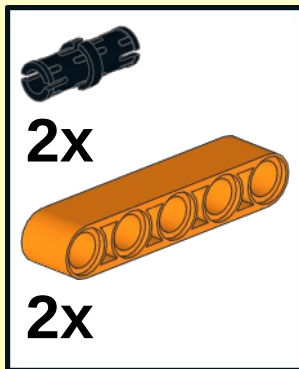

7

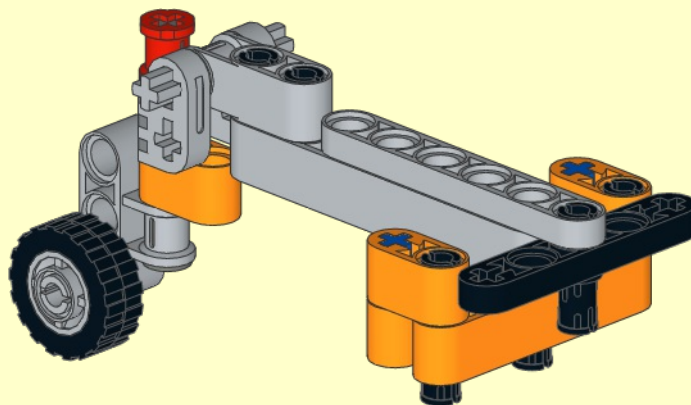
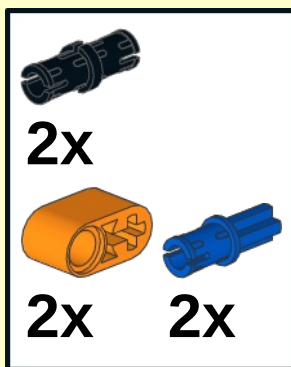

5

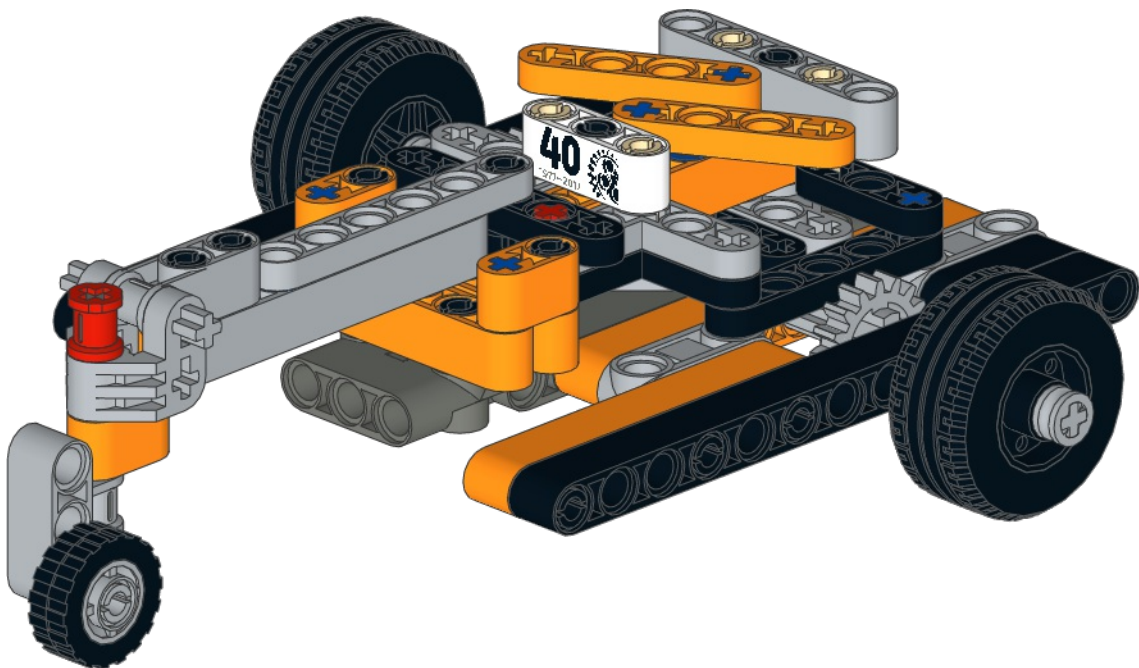

Congratulations, your chassis is ready.

If built correctly, it should move easily in all directions and the gears move synchronously with the wheels, i.e., the wheels can not spin without spinning the axle, due to the inserted rubber band.

For more instructions how to attach the motors and how to implement a simple robot, visit <http://wisslab.org/wissbot>.